

DRYWALL, WALL BOARD

OPEN STUDS, BLOCK

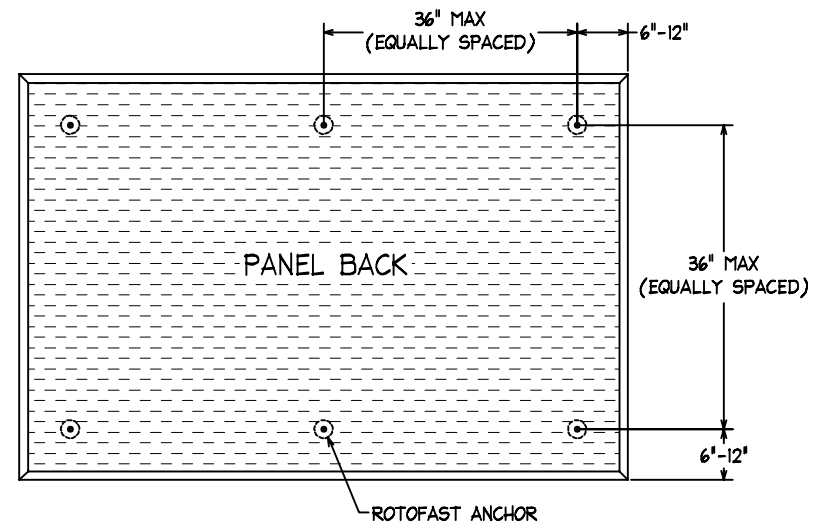

HARDSIDE HIGH IMPACT HARDSIDE TAD VERSATUNE SPORTSBOARD CONFORM SPORTSBOARD ELITE	
LONGEST EDGE OF PANEL	# OF ANCHORS
48" AND LESS	4
OVER 48" TO 84"	6
OVER 84" TO 120"	8

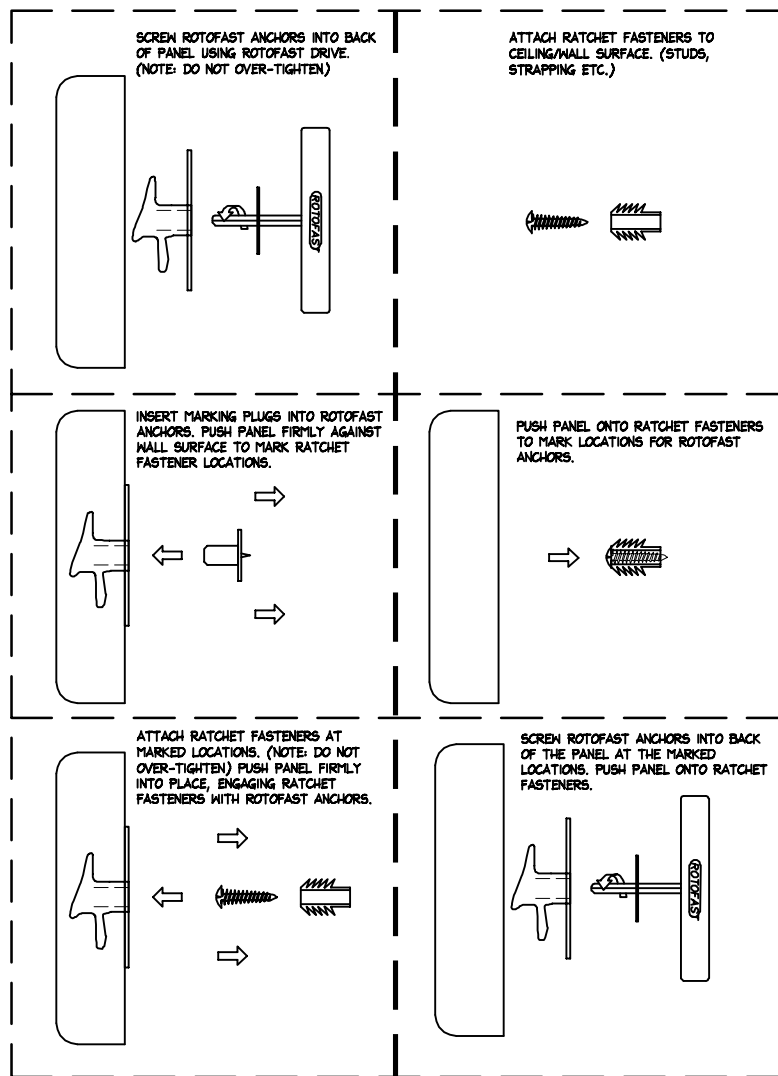
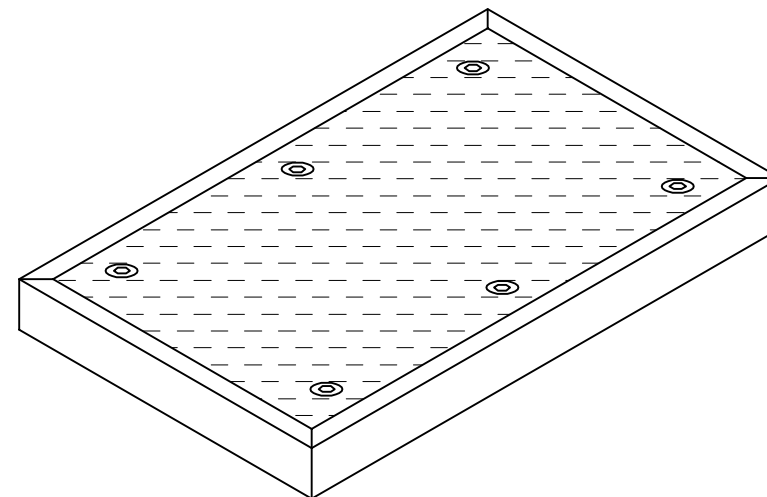

(ROTOFAST ANCHOR QUANTITY EXCEPTIONS)

- 4" HARDSIDE PANEL > 35.7 SF: (10) ANCHORS
- 4" HIGH IMPACT HARDSIDE PANEL > 32.7 SF: (10) ANCHORS
- 3" TAD PANEL > 34.7 SF: (10) ANCHORS
- 4" TAD PANEL 28.0-34.8 SF: (10) ANCHORS
- 4" TAD > 34.9 SF: (12) ANCHORS
- 3" VERSATUNE PANEL > 39.4 SF: (10) ANCHORS
- 4" VERSATUNE PANEL 31.0-38.5 SF: (10) ANCHORS
- 4" VERSATUNE PANEL > 38.6 SF: (12) ANCHORS

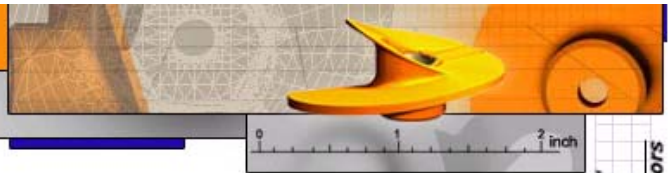

Rotofast Snap-On Anchor

Rotofast Snap-on Anchors are a secure and fast solution for acoustical panel installation. For ceilings or walls, the Rotofast Snap On anchor is the answer.

Installation Instructions



Rotofast Snap-On

Everything you need to install a panel in **5 EASY STEPS**.



1

Screw Rotofast Snap-On Anchors into the back of the panel using the Rotofast driver tool.



2

Insert marking plugs into the Snap-On anchors.



3

Push panel against wall to mark anchor locations.



4

Screw ratchets to wall at marked locations. (#8 screws recommended)



5

Firmly push panel onto ratchets to complete installation.

Ask your panel manufacturer or Rotofast representative for recommended anchor locations and quantities per panel.